

# PV-LR5

NO.:PV-LR5-01

Ver:A/2

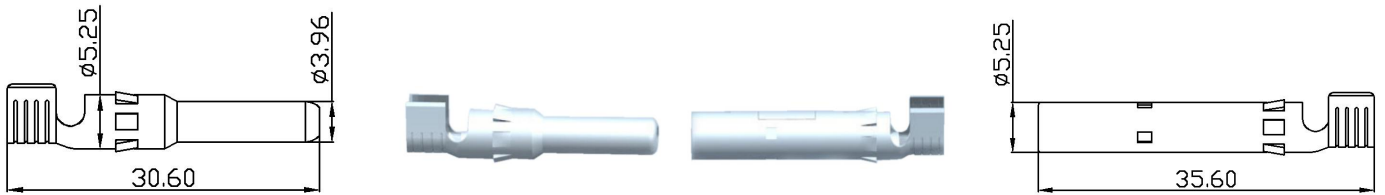
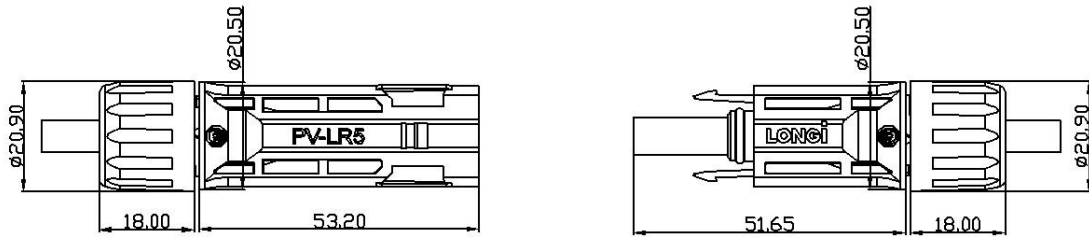

## 技术参数

## Technical data

额定电流 Rated current	30A
额定电压 Rated voltage	1500V(TUV) 1500V(UL)
插头连接器的接触电阻 Contact resistance	$\leq 0.5m\Omega$
连接线规格 Wire Type	4mm <sup>2</sup>
适用线缆外径 Suitable for cable outside diameter	I 型 $\phi 5.6mm < OD \leq \phi 6.6mm$ II 型 $\phi 6.6mm < OD \leq \phi 7.2mm$ III 型 $\phi 4.5mm < OD \leq \phi 5.6mm$

防护等级, 插合状态 Degree of protection, mated	IP68
触摸保护, 未插合状态 Degree of protection, unmated	IP2X
安全等级 Safety class	II
环境温度范围 Ambient temperature range	-40°C ... +85°C